

STEFFI-C-RF

GARDLER®



IS 10322(PART 5/SEC 2):2012
R-71007862



TRUNKING
PENDANT MOUNT-DOWN LIGHT

Driver	: Constant Current AC-DC
Input Voltage Range	: 220-240 V
Output Voltage	: 44V-52V DC
Output Current	: 600 mA, 800 mA, 1000 mA : 650 mA, 700 mA, 750 mA, 800 mA : 900 mA, 950 mA, 1050 mA
Power Factor	: >0.98
THD	: <10%

TECHNICAL SPECIFICATIONS

Light Source	: MPL-Mid Power LED
Power Consumption	: 30W, 34W, 36W, 38W, 42W, 48W, 50W, 56W
80 CRI	: 3000 K 3500 K 4000 K : 5700 K 6500 K

Wattage: 30W | 32W | 40W | 42W | 48W | 50W | 56W

PRODUCT HIGHLIGHTS

- Aesthetically designed trunking mounted luminaire
- Luminaire housing made from high-grade extruded aluminum
- High efficiency passive cooling technology for good thermal management
- Aesthetically designed micro prismatic wing shape high efficiency pc symmetric light distribution diffuser
- High efficacy SMD (Mid Powder) LED technology used in FR-4 PCB/MCPCB based on the wattage selection
- Isolated-high efficiency electronic driver mounted on the luminaire
- Complete luminaire is enclosed with abs-end cap
- Sliding clocking system-to suite trunking mounting
- Shade : powder coated-black, white

LED PARAMETERS

WATTS	CRI	COLOR TEMP.	LUMEN
30W	80	3000 K, 3500 K, 4000 K, 5700 K, 6500 K	3298 lm, 3321 lm, 3457 lm, 3521 lm, 3601 lm
32W		3000 K, 3500 K, 4000 K, 5700 K, 6500 K	3456 lm, 3563 lm, 3686 lm, 3802 lm, 3849 lm
40W		3000 K, 3500 K, 4000 K, 5700 K, 6500 K	4267 lm, 4389 lm, 4454 lm, 4564 lm, 4678 lm
42W		3000 K, 3500 K, 4000 K, 5700 K, 6500 K	4392 lm, 4442 lm, 4492 lm, 4592 lm, 4692 lm
48W	80	3000 K, 3500 K, 4000 K, 5700 K, 6500 K	4892 lm, 4942 lm, 4992 lm, 5091 lm, 5191 lm
50W		3000 K, 3500 K, 4000 K, 5700 K, 6500 K	5191 lm, 5241 lm, 5291 lm, 5391 lm, 5491 lm
56W		3000 K, 3500 K, 4000 K, 5700 K, 6500 K	5591 lm, 5640 lm, 5790 lm, 5890 lm, 5990 lm

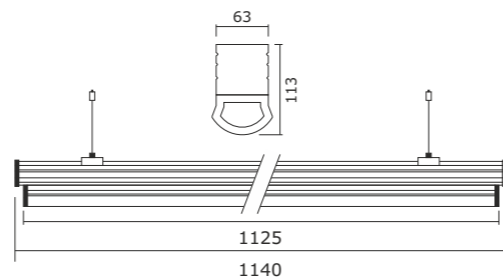

All dimensions are in mm

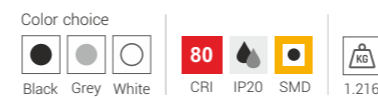

Application area for retail space:
Retail Space | Hyper / Supermarket

RF-PCGI TK60

GARDLER®



SUSPENDED TRUNKING

Technical Specification

Trunking made out of per-coated galvanised Iron... (GI sheet - pure zinc >99% continuously hot dip coated steel) and per- painted in process and roll formed.

Feature

Corrosion Resistance / Precisely Designed Unmatched Quality.

Wiring Specification

The trunking is wired with 2 single phase circuit (1sqmm single stand wires phase and neutral for peak and non - peak selection) and 1 emergency circuit (0.75sqmm single stand wires) for Inverter / UPS for emergency Lighting. With 1.5 sqmm Loop-in loop-out electrical connector for internal continuous wiring and tapping for luminaire connection.



SUSPENSION SYSTEM

Cord suspension using clix mechanism, the cord suspension can be fitted to trunking without the use of any tool by exerting slight pressure and it can also be moved as required, pendant height adjustments is also entirely tool-free.

CONNECTING JOINTS

Fabricated out of GI sheet steel with holes for connecting trunking one to one with screws to make continuous row system.

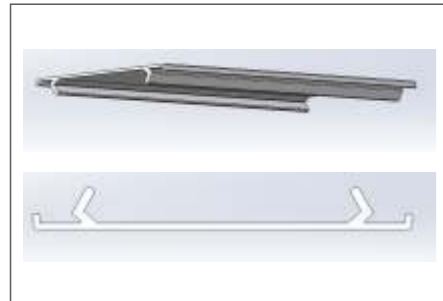

BOTTOM COVER

Made out of extruded PVC materials to be used as in-fill between the two luminaire and also at end of the trunking.

END CAP

Trunking end cap - made out of ABS plastic

SUSPENSION

Trunking suspension kit with ss material

